

IR Type Quartz Light Guides

Extended Infrared Grade IR - Silica core/PCS clad

| Spectral Curve | Specifications |
|---|---------------------------|
|  <p>Infrared Grade IR</p> | Individual Fiber Diameter |
| | Acceptance Cone |
| | Numerical Aperture |
| | Fiber Material |
| | Temperature capabilities |
| | Spectral Transmittance |
| | Minimum Bend Radius |
| | Maximum Breakage |

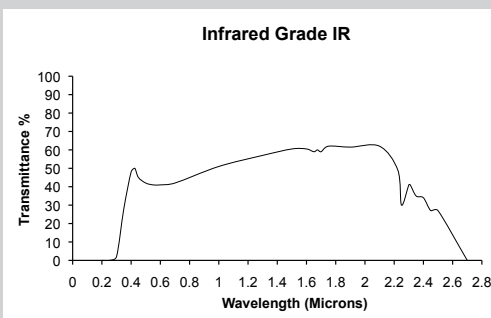
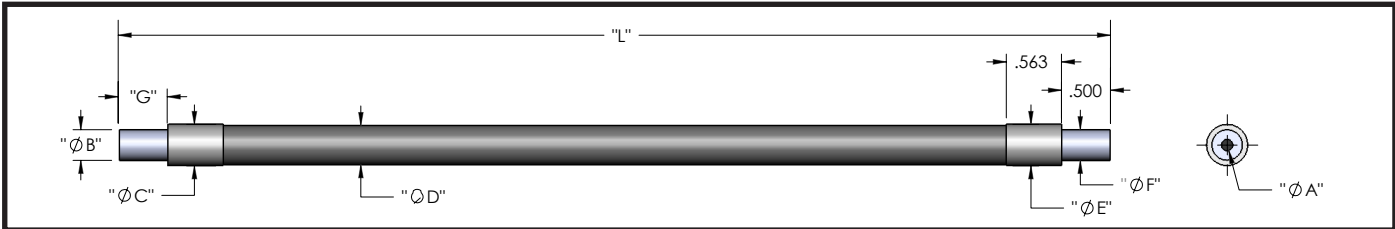

BIR - Standard End Ferrule, PVC Monocoil Sheathing, Rated for -40°F to 221°F

| Model | Part # | A | B | C | D | E | F | G | L |
|--------|--------------|----------|----------|----------|----------|----------|----------|----------|-----------------|
| BIR624 | 002012026024 | | | | | | | | 24" (609.60 mm) |
| BIR636 | 002012026036 | .062" | .187" | .205" | .190" | .205" | .187" | .50" | 36" (914.40 mm) |
| BIR672 | 002012026072 | (1.59mm) | (4.75mm) | (5.2mm) | (4.8mm) | (5.2mm) | (4.75mm) | (12.7mm) | 72" (1828.8 mm) |
| BIR824 | 002012028024 | | | | | | | | 24" (609.6 mm) |
| BIR836 | 002012028036 | .125" | .187" | .312" | .268" | .312" | .187" | .50" | 36" (914.40 mm) |
| BIR848 | 002012028048 | (3.18mm) | (4.75mm) | (7.92mm) | (6.81mm) | (7.92mm) | (4.75mm) | (12.7mm) | 48" (1219.2 mm) |
| BIR878 | 002012028078 | | | | | | | | 78" (1981.2 mm) |
| BIR424 | 002012024024 | .250" | .312" | .468" | .430" | .468" | .312" | .50" | 24" (609.60 mm) |
| BIR448 | 002012024048 | (6.35mm) | (7.92mm) | (11.9mm) | (10.9mm) | (11.9mm) | (7.92mm) | (12.7mm) | 48" (1219.2 mm) |



BXIR - Standard End Ferrule, Stainless Steel Sheathing, Rated for -40°F to 347°F

| Model | Part # | A | B | C | D | E | F | G | L |
|----------|--------------|----------|----------|----------|-----------|----------|----------|----------|------------------|
| BXIR624 | 002014026024 | .062" | .187" | .286" | .203" | .286" | .187" | .50" | 24" (609.60 mm) |
| BXIR636 | 002014026036 | (1.59mm) | (4.75mm) | (7.23mm) | (5.15 mm) | (7.23mm) | (4.75mm) | (12.7mm) | 36" (914.40 mm) |
| BXIR812 | 002014028012 | | | | | | | | 12" (304.80 mm) |
| BXIR824 | 002014028024 | | | | | | | | 24" (609.60 mm) |
| BXIR836 | 002014028036 | .125 | .187" | .375" | .345" | .375" | .187" | .50" | 36" (914.40 mm) |
| BXIR848 | 002014028048 | (3.18mm) | (4.75mm) | (9.52mm) | (8.76mm) | (9.52mm) | (4.75mm) | (12.7mm) | 48" (1219.2 mm) |
| BXIR884 | 002014028084 | | | | | | | | 84" (2133.6 mm) |
| BXIR8108 | 002014028108 | | | | | | | | 108" (2743.2 mm) |
| BXIR412 | 002014024012 | .250" | .312" | .615" | .560" | .615" | .312" | .50" | 12" (304.80 mm) |
| BXIR424 | 002014024024 | (6.35mm) | (7.92mm) | (15.6mm) | (14.22mm) | (15.6mm) | (7.92mm) | (12.7mm) | 24" (609.60 mm) |
| BXIR460 | 002014024060 | | | | | | | | 60" (1524.0 mm) |

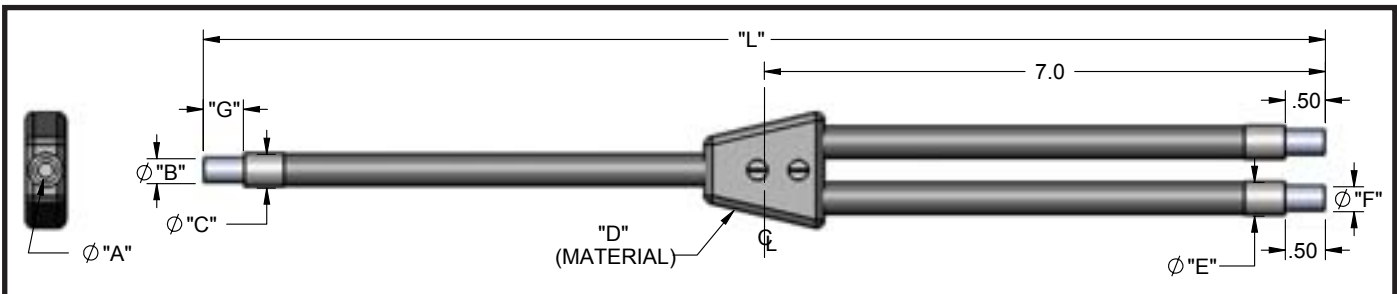

EIR- Standard End Ferrule, PVC Monocoil Sheathing, Rated for -40°F to 221°F

| Model | Part # | A | B | C | D | E | F | G | L |
|--------|--------------|----------|----------|----------|----------|----------|----------|----------|-----------------|
| EIR812 | 002022058012 | .125" | .187" | .312" | PVC Heat | .253" | .187" | .50" | 12" (304.80 mm) |
| EIR824 | 002022058024 | (3.18mm) | (4.75mm) | (7.92mm) | Shrink | (6.42mm) | (4.75mm) | (12.7mm) | 24" (609.60 mm) |
| EIR836 | 002022058036 | | | | | | | | 36" (914.40 mm) |
| EIR448 | 002022054048 | .250" | .312" | .468" | PVC Heat | .422" | .312" | .50" | 48" (1219.2 mm) |
| | | (6.35mm) | (7.92mm) | (11.9mm) | Shrink | (10.7mm) | (7.92mm) | (12.7mm) | |

Vision Light Tech B.V.

Protonenlaan 22, 5405 NE UDEN, P.O. Box 345, 5400 AH UDEN, The Netherlands

Phone: +31 (0)413 26 00 67, Fax +31 (0)413 26 09 38, E-mail: inquiry@vlt.nl, Website: www.vlt.nl

Trade register No. 17150044, VAT No. NL8112.30.946.B01