

E - Bifurcated Light Guide, Randomized, PVC Monocoil Sheathing, Rated for -40°F to 225°F

Model	Part #	A	B	C	D	E	F	G	L
E624	002122006024								24" (609.6 mm)
E636	002122006036		.187" (4.75 mm)	.205" (5.2 mm)	PVC Heat Shrink	.205" (5.2 mm)	.187" (4.75 mm)	.50" (12.7 mm)	36" (914.4 mm)
E648	002122006048	.063" (1.60 mm)	.187" (4.75 mm)	.205" (5.2 mm)	PVC Heat Shrink	.205" (5.2 mm)	.187" (4.75 mm)	.50" (12.7 mm)	48" (1219.2 mm)
E660	002122006060								60" (1523 mm)
E672	002122006072								72" (1828.8 mm)
E824	002122008024		.187" (4.75 mm)	.250" (6.3 mm)				.50" (12.7 mm)	24" (609.6 mm)
E836	002122008036		.187" (4.75 mm)	.250" (6.3 mm)				.50" (12.7 mm)	36" (914.4 mm)
E848	002122008048		.187" (4.75 mm)	.250" (6.3 mm)				.50" (12.7 mm)	48" (1219.2 mm)
E848M	002122530048	.125" (3.18 mm)	.588" (15 mm)	.615" (15.6 mm)	PVC Heat Shrink	.250" (6.3 mm)	.187" (4.75 mm)	.83" (21 mm)	48" (1219.2 mm)
E860	002122008060		.187" (4.75 mm)	.250" (6.3 mm)				.50" (12.7 mm)	60" (1523 mm)
E872	002122008072		.187" (4.75 mm)	.250" (6.3 mm)				.50" (12.7 mm)	72" (1828.8 mm)
E896	002122008096		.187" (4.75 mm)	.250" (6.3 mm)				.50" (12.7 mm)	96" (2438.4 mm)
E524	SK95900024	.156" (3.96 mm)	.187" (4.75 mm)	.312" (7.9 mm)	PVC Heat Shrink	.312" (7.9 mm)	.187" (4.75 mm)	.50" (12.7 mm)	24" (609.6 mm)
E536	SK95900036								36" (914.4 mm)
E572	SK95900072								72" (1828.8 mm)
E424	002122007024		.312" (7.9 mm)	.422" (10.7 mm)				.50" (12.7 mm)	24" (609.6 mm)
E436	002122007036		.312" (7.9 mm)	.422" (10.7 mm)				.50" (12.7 mm)	36" (914.4 mm)
E448	002122007048	.250" (6.3 mm)	.312" (7.9 mm)	.422" (10.7 mm)	PVC Heat Shrink	.422" (10.7 mm)	.312" (7.9 mm)	.50" (12.7 mm)	48" (1219.2 mm)
E448M	002122424048		.588" (15 mm)	.615" (15.6 mm)				.83" (21 mm)	48" (1219.2 mm)
E472	002122007072		.312" (7.9 mm)	.422" (10.7 mm)				.50" (12.7 mm)	72" (1828.8 mm)
E472M	002122424072		.588" (15 mm)	.615" (15.6 mm)				.83" (21 mm)	72" (1828.8 mm)

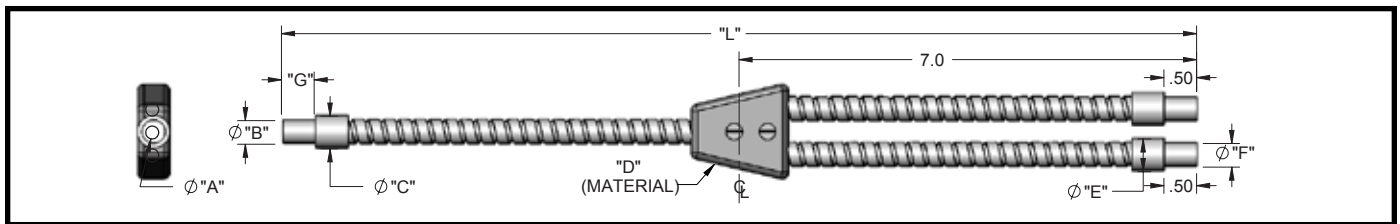

EX - Bifurcated Light Guide, Randomized, Stainless Steel Sheathing, Rated for -40°F to 225°F

Model	Part #	A	B	C	D	E	F	G	L
EX624	002124006024								24" (609.6 mm)
EX636	002124006036		.187" (4.75 mm)	-	Metal Transition	-	.187" (4.75 mm)	.50" (12.7 mm)	36" (914.4 mm)
EX672	002124006072	.063" (1.60 mm)	.187" (4.75 mm)	-	Metal Transition	-	.187" (4.75 mm)	.50" (12.7 mm)	72" (1828.8 mm)
EX824	002124008024		.187" (4.75 mm)	-				.50" (12.7 mm)	24" (609.6 mm)
EX836	002124008036		.187" (4.75 mm)	-				.50" (12.7 mm)	36" (914.4 mm)
EX848	002124008048	.125" (3.18 mm)	.187" (4.75 mm)	-	Metal Transition	-	.187" (4.75 mm)	.50" (12.7 mm)	48" (1219.2 mm)
EX860	002124008060								60" (1523 mm)
EX872	002124008072								72" (1828.8 mm)
EX424	SK78660024	.250" (6.3 mm)	.312" (7.9 mm)	-	PVC Heat Shrink	-	.312" (7.9 mm)	.50" (12.7 mm)	24" (609.6 mm)
EX448	SK78660048								48" (1219.2 mm)
EX472	SK78660072								72" (1828.8 mm)

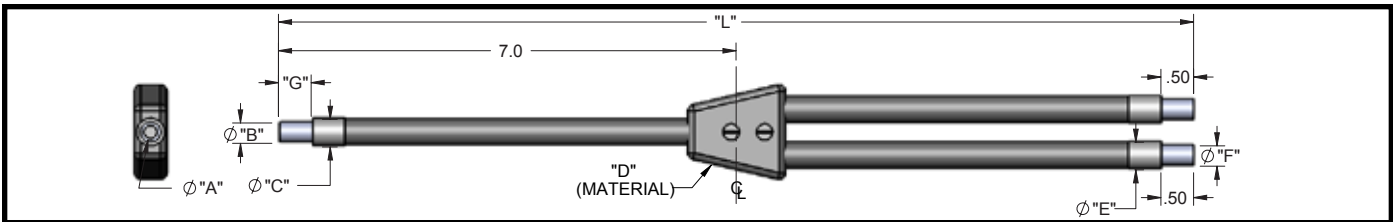

EE - Bifurcated Light Guide, Non-Randomized, PVC Monocoil Sheathing, Rated for -40°F to 225°F

Model	Part #	A	B	C	D	E	F	G	L
EE624	0021220106024								24" (609.6 mm)
EE636	0021220106036								36" (914.4 mm)
EE660	0021220106060	.063" (1.60 mm)	.187" (4.75 mm)	.205" (5.2 mm)	PVC Heat Shrink	.205" (5.2 mm)	.187" (4.75 mm)	.50" (12.7 mm)	60" (1523 mm)
EE672	0021220106072								72" (1828.8 mm)
EE696	0021220106096								96" (2438.4 mm)
EE824	002122008024		.187" (4.75 mm)	.250" (6.3 mm)				.50" (12.7 mm)	24" (609.6 mm)
EE836	002122008036		.187" (4.75 mm)	.250" (6.3 mm)				.50" (12.7 mm)	36" (914.4 mm)
EE836M	002122360036		.588" (15 mm)	.615" (15.6 mm)				.83" (21 mm)	36" (914.4 mm)
EE848	002122008048		.187" (4.75 mm)	.250" (6.3 mm)				.50" (12.7 mm)	48" (1219.2 mm)
EE860	002122008060	.125" (3.18 mm)	.187" (4.75 mm)	.250" (6.3 mm)	PVC Heat Shrink	.250" (6.3 mm)	.187" (4.75 mm)	.50" (12.7 mm)	60" (1523 mm)
EE860M	002122360060		.588" (15 mm)	.615" (15.6 mm)				.83" (21 mm)	60" (1523 mm)
EE872	002122008072		.187" (4.75 mm)	.250" (6.3 mm)				.50" (12.7 mm)	72" (1828.8 mm)
EE896	002122008096		.187" (4.75 mm)	.250" (6.3 mm)				.50" (12.7 mm)	96" (2438.4 mm)
EE8144	002122008144		.187" (4.75 mm)	.250" (6.3 mm)				.50" (12.7 mm)	144" (3655 mm)
EE8240	002122008240		.187" (4.75 mm)	.250" (6.3 mm)				.50" (12.7 mm)	240" (6096 mm)
EE412	002122014012		.312" (7.9 mm)	.422" (10.7 mm)				.50" (12.7 mm)	12" (305 mm)
EE424	002122014024		.312" (7.9 mm)	.422" (10.7 mm)				.50" (12.7 mm)	24" (609.6 mm)
EE424M	002122340024		.588" (15 mm)	.615" (15.6 mm)				.83" (21 mm)	24" (609.6 mm)
EE436	002122014036		.312" (7.9 mm)	.422" (10.7 mm)				.50" (12.7 mm)	36" (914.4 mm)
EE436M	002122340036		.588" (15 mm)	.615" (15.6 mm)				.83" (21 mm)	36" (914.4 mm)
EE448	002122014048	.250" (6.3 mm)	.312" (7.9 mm)	.422" (10.7 mm)	PVC Heat Shrink	.422" (10.7 mm)	.312" (7.9 mm)	.50" (12.7 mm)	48" (1219.2 mm)
EE448M	002122340048		.588" (15 mm)	.615" (15.6 mm)				.83" (21 mm)	48" (1219.2 mm)
EE460	002122014060		.312" (7.9 mm)	.422" (10.7 mm)				.50" (12.7 mm)	60" (1523 mm)
EE460M	002122340060		.588" (15 mm)	.615" (15.6 mm)				.83" (21 mm)	60" (1523 mm)
EE472	002122014072		.312" (7.9 mm)	.422" (10.7 mm)				.50" (12.7 mm)	72" (1828.8 mm)
EE472M	002122340072		.588" (15 mm)	.615" (15.6 mm)				.83" (21 mm)	72" (1828.8 mm)
EE496	002122014096		.312" (7.9 mm)	.422" (10.7 mm)				.50" (12.7 mm)	96" (2438.4 mm)
EE4120	002122014120		.312" (7.9 mm)	.422" (10.7 mm)				.50" (12.7 mm)	120" (3048 mm)

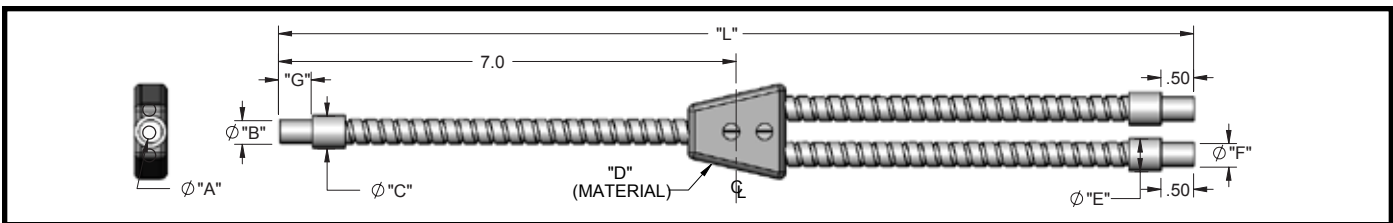

EEX - Bifurcated Light Guide, Non-Randomized, Stainless Steel Sheathing, Rated for -40°F to 225°F

Model	Part #	A	B	C	D	E	F	G	L
EEX836	SK78130036	.125" (3.18 mm)	.187" (4.75 mm)	-	Metal Transition	-	.187" (4.75 mm)	.50" (12.7 mm)	36" (914.4 mm)
EEX524	002124075024	.156" (3.96 mm)	.187" (4.75 mm)	-	Metal Transition	-	.187" (4.75 mm)	.50" (12.7 mm)	24" (609.6 mm)
EEX448	SK80080048		.312" (7.9 mm)	-	PVC Heat Shrink	-	.312" (7.9 mm)	.50" (12.7 mm)	48" (1219.2 mm)
EEX460	SK80080060	.250" (6.3 mm)	.312" (7.9 mm)	-	PVC Heat Shrink	-	.312" (7.9 mm)	.50" (12.7 mm)	60" (1523 mm)
EEX472	SK80080072		.312" (7.9 mm)	-	PVC Heat Shrink	-	.312" (7.9 mm)	.50" (12.7 mm)	72" (1828.8 mm)
EEX496	SK80080096		.312" (7.9 mm)	-	PVC Heat Shrink	-	.312" (7.9 mm)	.50" (12.7 mm)	96" (2438.4 mm)

Vision Light Tech B.V.

Protonenlaan 22, 5405 NE UDEN, P.O. Box 345, 5400 AH UDEN, The Netherlands

Phone: +31 (0)413 26 00 67, Fax +31 (0)413 26 09 38, E-mail: inquiry@vlt.nl, Website: www.vlt.nl

Trade register No. 17150044, VAT No. NL8112.30.946.B01