

Spot Lights HLV2 series

Refer to our website for product details.

CCS HLV2

Search



You can also use your smartphone or cell phone.

Use a search engine.

Provides high output spot lighting using an original optical design



HLV2-14/HLV2-14-HU

HLV2-22

HLV2-22-3W

HLV2-22-1220-3W

Applications

As a light source for a telecentric lens, light source for alignment of LCDs or circuit boards, light source for dimension measuring, and light source for spot illumination, etc.

Lineup with selection to match your needs

The HLV2 series provides a selection to match your usage environment and application. The LED color has a lineup of red, white, blue, and green.

HLV-14 series, with a lightweight and compact design

Compact model

The HLV2-14 series is perfect for saving space, with its lightweight and compact design.

Example connection with the lens



Weights just
18g



Spot Lights that achieve high output

The lightweight and compact Spot Light achieved high output through its unique optical design.

HLV2-22-3W series, a high output model

Standard model

HLV2-22 series



HLV2-22SW



Amount of light: 35% intensity

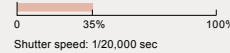

Shutter speed: 1/20,000 sec

High output model

The HLV2-22-3W series is a Spot Light with the highest output of all series.



HLV2-22SW-3W



Amount of light: 35% intensity

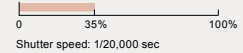

Shutter speed: 1/20,000 sec

* Brightness varies based on the camera's spectral sensitivity.

* The data included is for reference only and does not guarantee the quality of this product.

Custom orders

Please contact your CCS sales representative.

E.g.: Changed the LED emitted wavelength to infrared

Customizable items

External/Internal diameter

Wavelength/color

Increase output

Cable length

Illuminating angle

Format/material

Connector format

Installation/mounting

Etc.



Wavelength

Created an Infrared Light

Example configuration

Revised the optical system to increase the emitting efficiency for this high output Spot Light.

HLV2 series

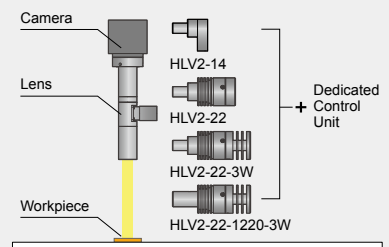

We have various materials.

PDF Drawings

DXF Drawings

3D CAD

Instruction Guides

Product Filers

Imaging Samples

Data Sheets

Examples of Custom Ordered Products

Download here.

<http://www.ccs-grp.com/dl/>

LDR2	Direct Lighting
LDR2-LA	
LDR-LA1	
SQR	
SQR-TP	
HLDR-IP	Convergent Lighting
HPR2	Diffused Lighting
HPR	
LFR	
LKR	
FPR	
FPQ2	Direct Lighting
LDL2	
LDLB	
HLDL2	
TH	
LFL	Diffused Lighting
HPD2	
HPD	
LDM2	
LAV	
PDM	Collimated Lighting
LFX2	
LFV3	
LFV2	
MSU	
MFU	Ultraviolet Lighting
UV2	
UV	
LNSP-UV-FN	
IR2	
HLV2	Spot Lighting, Etc.
LV	
LSP	
HFS/HFR	
HLV2-NR	
HLV2-3M-RGB-3W	
PFB2	
PFBR	
LNSP	
CU-LNSP	
LNSP-FN	Convergent Lighting
LN/LN-HK	
LNSD	
LND2	
HLND	
LT	Diffused Lighting
LNW/HLND	
LNIS	
LNSI-FN	
Telecentric Lens	
Macro Lens	Lenses

➤ Lineup offering a selection to match your needs

■ HLV2 series evaluation chart

	Brightness	Uniformity	Lightweight design	Compact design	Flexibility for installation	Energy savings
HLV2-14 [Standard type]	Good	Good	Very Good	Very Good	Good	Very Good
HLV2-14-HU [Uniform type]	OK	Very Good	Very Good	Very Good	Good	Very Good
HLV2-22 (Comparison criterion)	Good	Good	Good	Good	Good	Good
HLV2-22-3W	Very Good	Good	OK	OK	Very Good	Good
HLV2-22-1220-3W	Very Good	Good	OK	OK	Very Good	Good

■ HLV2 series evaluation graph

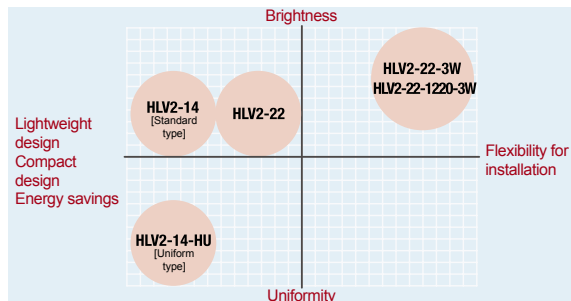

* Comparison using CCS products

➤ Imaging example: Imaging of 2-dimensional code



Description	Code reading
Workpiece	2-dimensional code
After the proposal	HLV2-22RD-3W

■ HLV2-22RD-3W

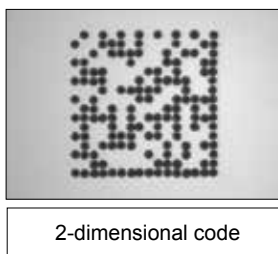

2-dimensional code

➤ Imaging example : Imaging of an alignment mark



Description	Positioning
Workpiece	Alignment mark
Light Unit in use	HLV2-22SW-3W

■ HLV2-22SW-3W



Alignment mark

Direct Lighting	LDR2 LDR2-LA LDR-LA1 SQR SQR-TP
Convergent Lighting	HLDR-IP
Diffused Lighting	HPR2 HPR LFR LKR FPR FPQ2
Direct Lighting	LDL2 LDLB HLDL2
Diffused Lighting	TH LFL HPD2 HPD LDM2 LAV PDM LFX2 LFX3 LFX2
Collimated Lighting	MSU MFU
Ultraviolet Lighting	UV2 UV LNSP-UV-FN
Infrared Lighting	IR2
Spot Lighting, Etc.	HLV2 LV LSP HFS/HFR HLV2-NR HLV2-3M-RGB-3W PFB2 PFBR
Convergent Lighting	LNSP CU-LNSP LNSP-FN LN/LN-HK
Diffused Lighting	LNSD LND2 HLND LT LNV/HLDN
Oblique Angled Lighting	LNIS LNIS-FN
Lenses	Telecentric Lens Macro Lens

HLV2 series



Refer to our website for product details.

CCS HLV2

Search



You can also use your smartphone or cell phone.

Use a search engine.

Comparison of data for the HLV2-14 series

Brightness comparison between the HLV2-14 and HLV2-14-HU

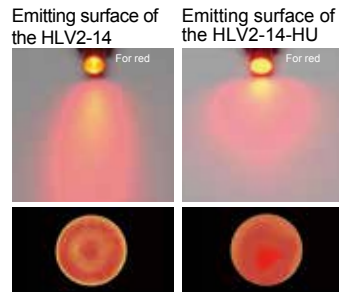
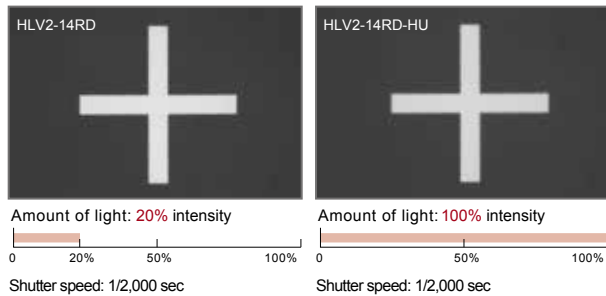

The HLV2-14-HU is a Spot Light with a highly uniform emitting surface.

* Comparison using CCS products
* This data is for reference only.
(This does not guarantee product quality.)

Lineup

Model name	LED color	Power consumption	Peak wavelength/ correlated color temperature	Options	Recommended Control Units	Weight
HLV2-14RD	Red	0.9 W	645 nm	-	<input type="checkbox"/> PD3* <input type="checkbox"/> CC-PJ-0707 <input type="checkbox"/> PJ	18 g
HLV2-14SW	White		5,300 K			
HLV2-14BL	Blue		465 nm			
HLV2-14GR	Green		520 nm			
HLV2-14RD-HU	Red	0.9 W	645 nm	-	<input type="checkbox"/> PD3* <input type="checkbox"/> CC-PJ-0707 <input type="checkbox"/> PJ	18 g
HLV2-14SW-HU	White		4,700 K			
HLV2-14BL-HU	Blue		465 nm			
HLV2-14GR-HU	Green		520 nm			
HLV2-22RD	Red	1.4 W	645 nm	<input type="checkbox"/> Convergent lens	<input type="checkbox"/> PD3* <input type="checkbox"/> CC-PJ-0707 <input type="checkbox"/> PJ	37 g
HLV2-22SW	White		5,300 K			
HLV2-22BL	Blue		465 nm			
HLV2-22GR	Green		520 nm			
HLV2-22RD-3W	Red	2.8 W	645 nm	<input type="checkbox"/> Convergent lens	<input type="checkbox"/> PD3* <input type="checkbox"/> CC-PJ-0707 <input type="checkbox"/> PJ	41g
HLV2-22SW-3W	White		5,300 K			
HLV2-22BL-3W	Blue		465 nm			
HLV2-22GR-3W	Green		520 nm			
HLV2-22RD-1220-3W	Red	2.8 W	645 nm	-	<input type="checkbox"/> PD3* <input type="checkbox"/> CC-PJ-0707 <input type="checkbox"/> PJ	42 g
HLV2-22SW-1220-3W	White		5,300 K			
HLV2-22BL-1220-3W	Blue		465 nm			
HLV2-22GR-1220-3W	Green		520 nm			

Extension Cables ▶ P.222

Control Unit Selection Guide ▶ P.181

Control Unit Page ▶ P.185

* The PD3-3024-3 and PD3-5024-3 series are not applicable to these products.

Caution

- The length of the extension cable must be 5 m or less. If you would like to use longer than 5 m, please contact your CCS sales representative.
- Branch cables cannot be used. Use the FCB series (straight cable) or the FRCB series (robot cable).

LED properties

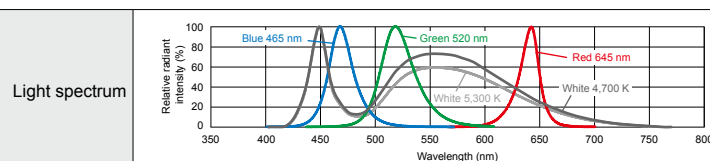

If using a sharp-cut filter, please use the R60 (option). For details about the sharp-cut filter, refer to P.215.

Be sure to read the "Instruction Guide" included with the product before use and observe cautionary information. The data included is for reference only and does not guarantee the quality of this product.

We have various materials.

PDF Drawings

DXF Drawings

3D CAD

Instruction Guides

Product Filers

Imaging Samples

Data Sheets

Examples of Custom Ordered Products

Download here.

<http://www.ccs-grp.com/dl/>

Dimensions (mm)

HLV2-14RD/SW/BL/GR/RD-HU/SW-HU/BL-HU/GR-HU

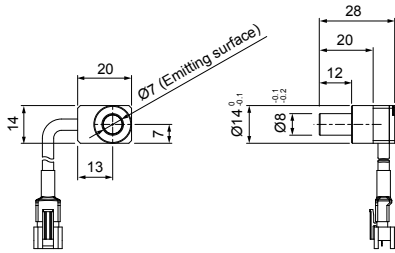

HLV2-22RD/SW/BL/GR

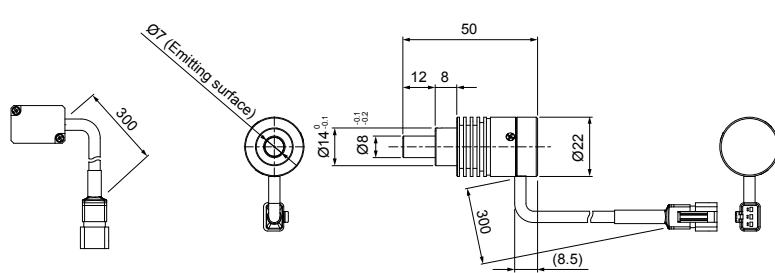

HLV2-22RD-3W/SW-3W/BL-3W/GR-3W

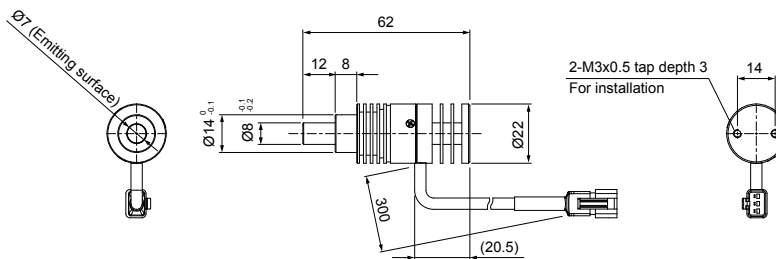

HLV2-22RD-1220-3W/SW-1220-3W/BL-1220-3W/GR-1220-3W

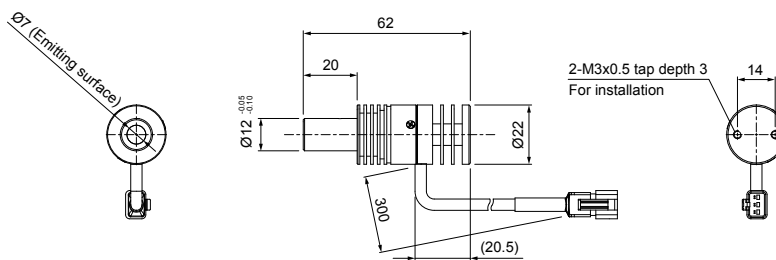

Options

HLV2-22 series dedicated convergent lens HL-30/HL-24-21



* Cannot be used with the HLV2-14/HLV2-22-1220-3W/HLV2-22-NR-3W series.

■ Illuminated range of the HL-30/HL-24-21

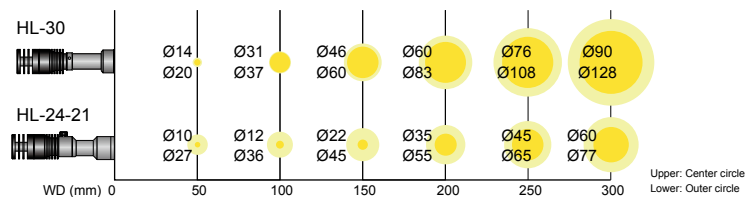

* This data is actual measurement values. (This does not guarantee product quality.)

■ Installation with the HLV2-22 series

Dimensions (mm)

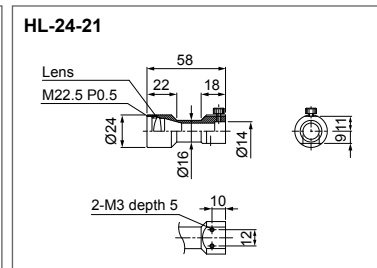
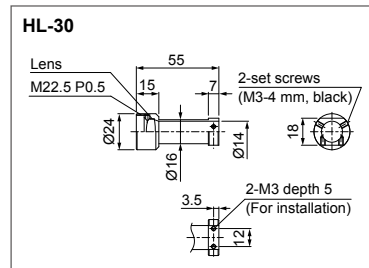
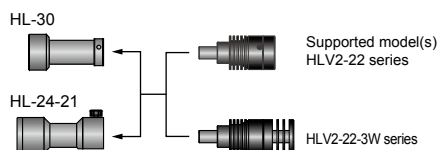

Direct Lighting	LDR2
	LDR2-LA
	LDR-LA1
	SQR
	SQR-TP
Convergent Lighting	HLDR-IP
Diffused Lighting	HPR2
	HPR
	LFR
	LKR
	FPR
	FPQ2
Direct Lighting	LDL2
	LDLB
	HLDL2
	TH
Diffused Lighting	LFL
	HPD2
	HPD
	LDM2
	LAV
	PDM
	LFX2
	LFV3
	LFV2
Colimated Lighting	MSU
	MFU
Ultraviolet Lighting	UV2
	UV
Infrared Lighting	LNSP-UV-FN
	IR2
Spot Lighting, Etc.	HLV2
	LV
	LSP
	HFS/HFR
	HLV2-NR
	HLV2-3M-RGB-3W
	PFB2
PFBR	
Convergent Lighting	LNSP
	CU-LNSP
	LNSP-FN
Diffused Lighting	LN/LN-HK
	LNSD
	LND2
	HLND
Oblique Angled Lighting	LT
	LN/HLDN
Lenses	LNIS
	LNIS-FN
	Telecentric Lens
	Macro Lens