

MetaBright™ High Power Diffuse Do

Model#: MB-DL406



- Size: 7" I.D./10" O.D.
- Patent-pending LED heat management for consistent performance
- High intensity and uniform, non-directional illumination across entire lighting hemisphere for area scan
- Ideal for highly reflective surfaces and textured or topographic objects
- Provides cloudy day illumination, minimizing shadows and glare
- Enclosed workspace blocks interference of ambient light
- Optical grade reflector coating reflects 99.9% of light for optimum diffused output
- Strobe & dimming options
- Mounting: Comes with mounting studs

Specifications:

Current Consumption	1.59A
Housing	Aluminium
Finish	Powder Coated Black
Intensity Uniformity	+/-5%
Operating Temperature	120° F Max
Illuminance	68,000 Lux
Compliance	CE/RoHS
Lifetime Hours	75,000 Hours

Wiring Diagram

Flying Leads	Function
RED	+24VDC
WHITE	0~10V
BLACK	Ground
GREEN	Signal Ground

24 AWG 4 WIRES CABLE X 1
 When not using intensity control, connect 0-10V control line to +24 (Max Intensity Control = 25V) and intensity control ground to ground

M12 Connector

PIN #	Function
1	+24VDC
2	0-10VDC Intensity Control
3	Ground
4	Signal Ground

Active Area Dimensions Camera Aperture

Active Area	Dimensions	Camera Aperture
7" I.D. 177.8mm	5.16in x 11.62in 131.1mm x 295.3mm	1in 25.4mm

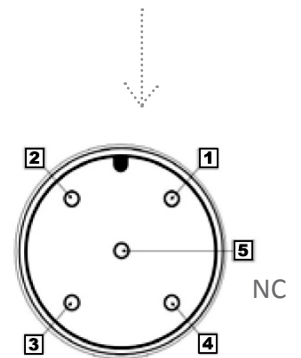

ORDERING INFORMATION:

• MB-DL406	-	<input type="checkbox"/>	- 2 4 -	<input type="checkbox"/>	
		W	White 6000k	*BLANK	10 ft. Flying Leads
		R	Red 630nm	T	M12 Quick Disconnect
		G	Green 530nm	ILD	In Line Dimmer
		B	Blue 455 nm	ILS	In Line Strobe (customer provide trigger info)
		IRN	Infrared 850nm	LL	Long Focal Lens
		RGB	625/530/455nm		

MetaBright™ High Power Diffuse Dome Light

Model#: MB-DL406

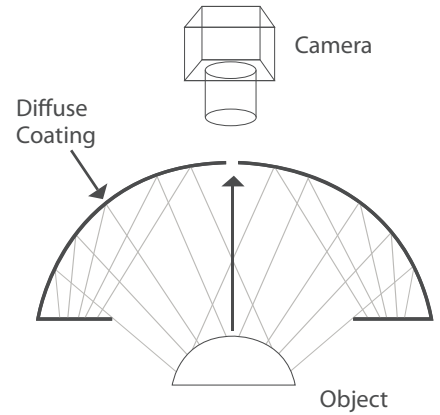

Drawing

REVISIONS				
ZONE	REV.	DESCRIPTION	DATE	APPROVED
	B	REDRAWN IN SOLIDWORKS, KIW	5/10/2012	

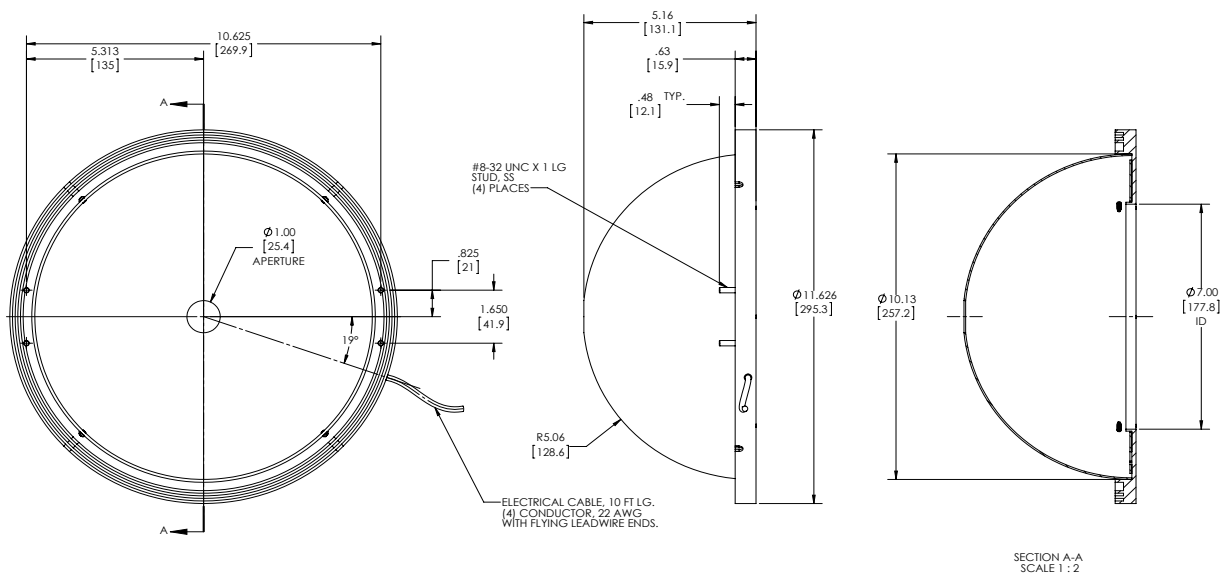

UNLESS OTHERWISE SPECIFIED:		NAME	DATE	METAPHASE TECHNOLOGIES, INC.
DRAWING	INCHES	KIW	5/10/2012	TITLE:
TOLERANCES:	FRACTIONS			DOME LIGHT, 7 INCH, ID
ANGULAR MATCH	MINUS			SIZE (DWG. NO.)
THREE PLACE DECIMAL	PER			C DL406
				SCALE: NTS
				REV B
				SHEET 1 OF 1