



## High Quality Machine Vision Lens

### 22HA

- High Resolution Lens
- Higher Close Up Capability
- ultra low distortion
- Compact Design



P/N	22HA	
Imager size	2/3"	
Mount	C-Mount	
Focal length	6.5mm	
Aperture	F/ 1.8	
Angle of View (horizontal x vertical)	2/3"	71.6° x 55.5°
	1/2"	53.9° x 41.0°
	1/3"	41.0° x 31.0°
Focusing range	1.5m - ∞	
Operation	Focus	-
	Iris	Manual w/lock
Filter size	M35.5mm P=0.5mm	
Back focus (in air)	13.00mm	
Exit Pupil Position	-31.8mm	
Optical Construction	6 groups / 7 elements	
Distortion	-2.16% (distance 0.5m)	
Optical Overall Length	35.40mm	
Maximum Diameter	37mm	
Weight	60g	
Operating Temperature	-5 ~ 50°C	

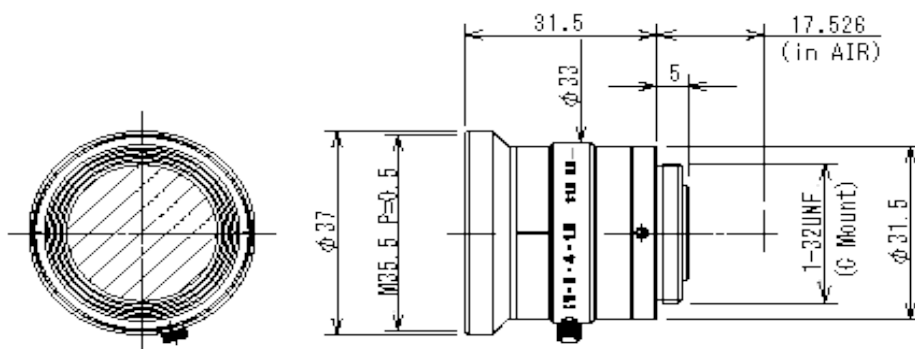

#### Vision Light Tech B.V.

Protonenlaan 22, 5405 NE UDEN, P.O. Box 345, 5400 AH UDEN, The Netherlands

Phone: +31 (0)413 26 00 67, Fax +31 (0)413 26 09 38, E-mail: [inquiry@vlt.nl](mailto:inquiry@vlt.nl), Website: [www.vlt.nl](http://www.vlt.nl)

Trade register No. 17150044, VAT No. NL8112.30.946.B01