



# 5 MEGAPIXEL LENSES for Machine Vision

- Focal Length of 8mm, 16mm, 25mm
- Ultra-high Resolution
- Highest Contrast
- Fast Aperture
- Robust & Durable
- Compact Design
- Locking Screws
- Extremely Low Distortion
- Bright to the Periphery

**RICOH**  
imagine. change.

# 5 Megapixel LENSES, FIXED FOCAL LENGTH

## Manual Iris, with Locking Screws

Part No.	Format size	Mount	Focal length (mm)	Iris range	M. O. D. (m)	Horizontal angle of view	Filter size (mm)	Dimensions (mm)	Specials	Price (Euro)
----------	-------------	-------	-------------------	------------	--------------	--------------------------	------------------	-----------------	----------	--------------

### HIGH-RESOLUTION, FOR STANDARD, IP AND MEGAPIXEL CAMERAS

FL-CC0814-5M	2/3"	C	8	1.4 - 16	0.1	57.8°	58.0	Ø60.8 × 64.0		499.00
FL-CC1614-5M	2/3"	C	16	1.4 - 16	0.1	30.8°	40.5	Ø43.0 × 47.0		399.00
FL-CC2514-5M	2/3"	C	25	1.4 - 16	0.1	19.9°	40.5	Ø43.0 × 44.0		399.00

This series of high-res fixed focal lenses are designed to match the requirements of highly developed machine vision systems. The lens isn't only optimized for highest image quality, but also for heavy duty industrial operation.

They are perfect for inspection, pattern matching, and alignment uses in which images with high definition from edge to edge definition are needed for large subjects such as wafers, chip mounters, board mounting, etc.

- Compatible with pixel size 3.45µm, 5 megapixel on 2/3" cameras
- High resolving power of 140 lp/mm from centre to corners of the image
- 1% or less distortion, suitable for image measurement
- 40% increased light distribution
- Fast aperture F1.4
- Ideal for integration in highly developed machine vision systems
- Stable design, robust and durable
- With locking and thumb screws

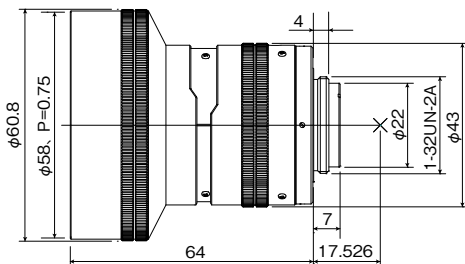

FL-CC0814-5M

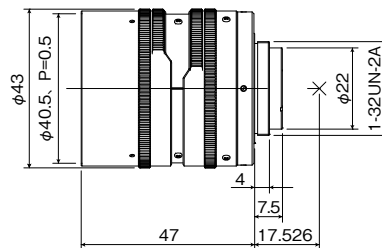

FL-CC1614-5M

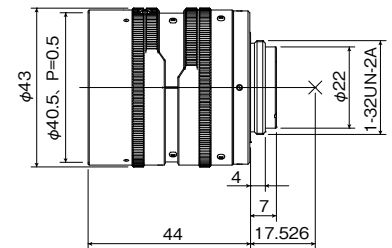

FL-CC2514-5M

Unit: mm

