

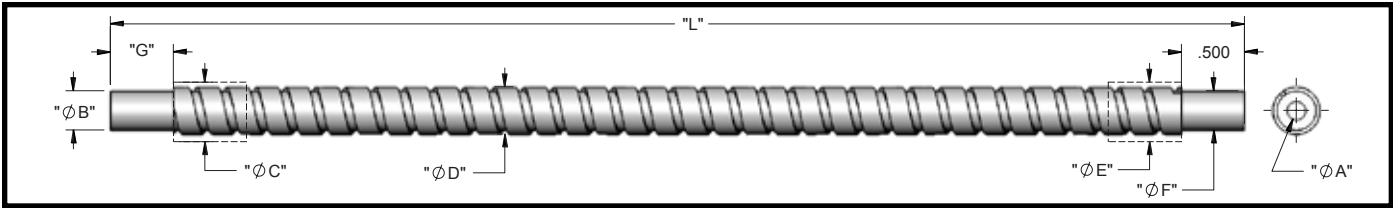

B - Standard End Ferrule, PVC Monocoil Sheathing, Rated for -40°F to 225°F

Model	Part #	A	B	C	D	E	F	G	L
B624	002112003024		.187" (4.75 mm)	.205" (5.2 mm)	.190" (4.8 mm)	.205" (5.2 mm)		.50" (12.7 mm)	24" (609.6 mm)
B624M	700009680024		.588" (15 mm)	.615" (15.6 mm)	.230" (5.8 mm)	.250" (6.3 mm)		.83" (21 mm)	24" (609.6 mm)
B636	002112003036		.187" (4.75 mm)	.205" (5.2 mm)	.190" (4.8 mm)	.205" (5.2 mm)		.50" (12.7 mm)	36" (914.4 mm)
B636M	700009680036	.063" (1.60 mm)	.588" (15 mm)	.615" (15.6 mm)	.230" (5.8 mm)	.250" (6.3 mm)	.187" (4.75 mm)	.83" (21 mm)	36" (914.4 mm)
B648	002112003048		.187" (4.75 mm)	.205" (5.2 mm)	.190" (4.8 mm)	.205" (5.2 mm)		.50" (12.7 mm)	48" (1219.2 mm)
B648M	700009680048		.588" (15 mm)	.615" (15.6 mm)	.230" (5.8 mm)	.250" (6.3 mm)		.83" (21 mm)	48" (1219.2 mm)
B672	002112003072		.187" (4.75 mm)	.205" (5.2 mm)	.190" (4.8 mm)	.205" (5.2 mm)		.50" (12.7 mm)	72" (1828.8 mm)
B672M	700009680072		.588" (15 mm)	.615" (15.6 mm)	.230" (5.8 mm)	.250" (6.3 mm)		.83" (21 mm)	72" (1828.8 mm)
B824	002112005024		.187" (4.75 mm)	.250" (6.3 mm)				.50" (12.7 mm)	24" (609.6 mm)
B824M	002112520024		.588" (15 mm)	.615" (15.6 mm)				.83" (21 mm)	24" (609.6 mm)
B836	002112005036		.187" (4.75 mm)	.250" (6.3 mm)				.50" (12.7 mm)	36" (914.4 mm)
B836M	002112520036		.588" (15 mm)	.615" (15.6 mm)				.83" (21 mm)	36" (914.4 mm)
B848	002112005048		.187" (4.75 mm)	.250" (6.3 mm)				.50" (12.7 mm)	48" (1219.2 mm)
B848M	002112520048		.588" (15 mm)	.615" (15.6 mm)				.83" (21 mm)	48" (1219.2 mm)
B860	002112005060		.187" (4.75 mm)	.250" (6.3 mm)				.50" (12.7 mm)	60" (1523 mm)
B860M	002112520060		.588" (15 mm)	.615" (15.6 mm)				.83" (21 mm)	60" (1523 mm)
B872	002112005072	.125" (3.18 mm)	.187" (4.75 mm)	.250" (6.3 mm)	.230" (5.8 mm)	.250" (6.3 mm)	.187" (4.75 mm)	.50" (12.7 mm)	72" (1828.8 mm)
B872M	002112520072		.588" (15 mm)	.615" (15.6 mm)				.83" (21 mm)	72" (1828.8 mm)
B896	002112005096		.187" (4.75 mm)	.250" (6.3 mm)				.50" (12.7 mm)	96" (2438.4 mm)
B896M	002112520096		.588" (15 mm)	.615" (15.6 mm)				.83" (21 mm)	96" (2438.4 mm)
B8120	002112005120		.187" (4.75 mm)	.250" (6.3 mm)				.50" (12.7 mm)	120" (3048 mm)
B8120M	002112520120		.588" (15 mm)	.615" (15.6 mm)				.83" (21 mm)	120" (3048 mm)
B8144	002112005144		.187" (4.75 mm)	.250" (6.3 mm)				.50" (12.7 mm)	144" (3655 mm)
B8144M	002112520144		.588" (15 mm)	.615" (15.6 mm)				.83" (21 mm)	144" (3655 mm)
B8240	002112005240		.187" (4.75 mm)	.250" (6.3 mm)				.50" (12.7 mm)	240" (6096 mm)
B536	SK96830036	.156" (3.96 mm)	.187" (4.75 mm)	.312" (7.9 mm)	.270" (6.85 mm)	.312" (7.9 mm)	.187" (4.75 mm)	.50" (12.7 mm)	36" (914.4 mm)
B548	SK96830048							.50" (12.7 mm)	48" (1219.2 mm)
B572	SK96830072							.50" (12.7 mm)	72" (1828.8 mm)
B424	002112007024		.312" (7.9 mm)	.422" (10.7 mm)				.50" (12.7 mm)	24" (609.6 mm)
B424M	002112424024		.588" (15 mm)	.615" (15.6 mm)				.83" (21 mm)	24" (609.6 mm)
B436	002112007036		.312" (7.9 mm)	.422" (10.7 mm)				.50" (12.7 mm)	36" (914.4 mm)
B436M	002112424036		.588" (15 mm)	.615" (15.6 mm)				.83" (21 mm)	36" (914.4 mm)
B448	002112007048		.312" (7.9 mm)	.422" (10.7 mm)				.50" (12.7 mm)	48" (1219.2 mm)
B448M	002112424048		.588" (15 mm)	.615" (15.6 mm)				.83" (21 mm)	48" (1219.2 mm)
B460	002112007060		.312" (7.9 mm)	.422" (10.7 mm)				.50" (12.7 mm)	60" (1523 mm)
B460M	002112424060		.588" (15 mm)	.615" (15.6 mm)				.83" (21 mm)	60" (1523 mm)
B472	002112007072		.312" (7.9 mm)	.422" (10.7 mm)				.50" (12.7 mm)	72" (1828.8 mm)
B472M	002112424072	.250" (6.3 mm)	.588" (15 mm)	.615" (15.6 mm)	.40" (10.2 mm)	.422" (10.7 mm)	.312" (7.9 mm)	.83" (21 mm)	72" (1828.8 mm)
B484	002112007084		.312" (7.9 mm)	.422" (10.7 mm)				.50" (12.7 mm)	84" (2132 mm)
B484M	002112424084		.588" (15 mm)	.615" (15.6 mm)				.83" (21 mm)	84" (2132 mm)
B496	002112007096		.312" (7.9 mm)	.422" (10.7 mm)				.50" (12.7 mm)	96" (2438.4 mm)
B496M	002112424096		.588" (15 mm)	.615" (15.6 mm)				.83" (21 mm)	96" (2438.4 mm)
B4120	002112007120		.312" (7.9 mm)	.422" (10.7 mm)				.50" (12.7 mm)	120" (3048 mm)
B4120M	002112424120		.588" (15 mm)	.615" (15.6 mm)				.83" (21 mm)	120" (3048 mm)
B4144	002112007144		.312" (7.9 mm)	.422" (10.7 mm)				.50" (12.7 mm)	144" (3655 mm)
B4144M	002112424144		.588" (15 mm)	.615" (15.6 mm)				.83" (21 mm)	144" (3655 mm)
B4240	002112007240		.312" (7.9 mm)	.422" (10.7 mm)				.50" (12.7 mm)	240" (6096 mm)
B4240M	002112424240		.588" (15 mm)	.615" (15.6 mm)				.83" (21 mm)	240" (6096 mm)
B3736	700014930036	.375" (9.5 mm)	.562" (14.26 mm)	.75" (19 mm)	.67" (17 mm)	.75" (19 mm)	.562" (14.26 mm)	.50" (12.7 mm)	36" (914.4 mm)
B3748	700014930048							.50" (12.7 mm)	48" (1219.2 mm)
B3772	700014930072							.50" (12.7 mm)	72" (1828.8 mm)
B236	700014920036	.50" (12.7 mm)	.562" (14.26 mm)	.875" (22.2 mm)	.76" (19.3 mm)	.875" (22.2 mm)	.562" (14.26 mm)	.50" (12.7 mm)	36" (914.4 mm)
B248	700014920048							.50" (12.7 mm)	48" (1219.2 mm)
B272	700014920072							.50" (12.7 mm)	72" (1828.8 mm)



BX - Standard End Ferrule, PVC Monocoil Sheathing, Rated for -40°F to 500°F

Model	Part #	A	B	C	D	E	F	G	L
BX612	002114106012								12" (305 mm)
BX624	002114106024								24" (609.6 mm)
BX636	002114106036	.063" (1.60 mm)	.187" (4.75 mm)	-	.203" (5.15 mm)	-	.187" (4.75 mm)	.50" (12.7 mm)	36" (914.4 mm)
BX648	002114106048								48" (1219.2 mm)
BX660	002114106060								60" (1523 mm)
BX672	002114106072								72" (1828.8 mm)
BX824	002112005024		.187" (4.75 mm)	.250" (6.3 mm)				.50" (12.7 mm)	24" (609.6 mm)
BX824M	002112520024		.588" (15 mm)	.615" (15.6 mm)				.83" (21 mm)	24" (609.6 mm)
BX836	002112005036		.187" (4.75 mm)	.250" (6.3 mm)				.50" (12.7 mm)	36" (914.4 mm)
BX836M	002112520036		.588" (15 mm)	.615" (15.6 mm)				.83" (21 mm)	36" (914.4 mm)
BX848	002112005048		.187" (4.75 mm)	.250" (6.3 mm)				.50" (12.7 mm)	48" (1219.2 mm)
BX848M	002112520048		.588" (15 mm)	.615" (15.6 mm)				.83" (21 mm)	48" (1219.2 mm)
BX860	002112005060		.187" (4.75 mm)	.250" (6.3 mm)				.50" (12.7 mm)	60" (1523 mm)
BX860M	002112520060		.588" (15 mm)	.615" (15.6 mm)				.83" (21 mm)	60" (1523 mm)
BX872	002112005072	.125" (3.18 mm)	.187" (4.75 mm)	.250" (6.3 mm)	.230" (5.8 mm)	.250" (6.3 mm)	.187" (4.75 mm)	.50" (12.7 mm)	72" (1828.8 mm)
BX872M	002112520072		.588" (15 mm)	.615" (15.6 mm)				.83" (21 mm)	72" (1828.8 mm)
BX896	002112005096		.187" (4.75 mm)	.250" (6.3 mm)				.50" (12.7 mm)	96" (2438.4 mm)
BX896M	002112520096		.588" (15 mm)	.615" (15.6 mm)				.83" (21 mm)	96" (2438.4 mm)
BX8120	002112005120		.187" (4.75 mm)	.250" (6.3 mm)				.50" (12.7 mm)	120" (3048 mm)
BX8120M	002112520120		.588" (15 mm)	.615" (15.6 mm)				.83" (21 mm)	120" (3048 mm)
BX8144	002112005144		.187" (4.75 mm)	.250" (6.3 mm)				.50" (12.7 mm)	144" (3655 mm)
BX8144M	002112520144		.588" (15 mm)	.615" (15.6 mm)				.83" (21 mm)	144" (3655 mm)
BX8240	002112005240		.187" (4.75 mm)	.250" (6.3 mm)				.50" (12.7 mm)	240" (6096 mm)
BX536	SK96830036	.156" (3.96 mm)	.187" (4.75 mm)	.312" (7.9 mm)	.270" (6.85 mm)	.312" (7.9 mm)	.187" (4.75 mm)	.50" (12.7 mm)	36" (914.4 mm)
BX548	SK96830048							.50" (12.7 mm)	48" (1219.2 mm)
BX572	SK96830072							.50" (12.7 mm)	72" (1828.8 mm)
BX424	002112007024		.312" (7.9 mm)	.422" (10.7 mm)				.50" (12.7 mm)	24" (609.6 mm)
BX424M	002112424024		.588" (15 mm)	.615" (15.6 mm)				.83" (21 mm)	24" (609.6 mm)
BX436	002112007036		.312" (7.9 mm)	.422" (10.7 mm)				.50" (12.7 mm)	36" (914.4 mm)
BX436M	002112424036		.588" (15 mm)	.615" (15.6 mm)				.83" (21 mm)	36" (914.4 mm)
BX448	002112007048		.312" (7.9 mm)	.422" (10.7 mm)				.50" (12.7 mm)	48" (1219.2 mm)
BX448M	002112424048		.588" (15 mm)	.615" (15.6 mm)				.83" (21 mm)	48" (1219.2 mm)
BX460	002112007060		.312" (7.9 mm)	.422" (10.7 mm)				.50" (12.7 mm)	60" (1523 mm)
BX460M	002112424060		.588" (15 mm)	.615" (15.6 mm)				.83" (21 mm)	60" (1523 mm)
BX472	002112007072		.312" (7.9 mm)	.422" (10.7 mm)				.50" (12.7 mm)	72" (1828.8 mm)
BX472M	002112424072	.250" (6.3 mm)	.588" (15 mm)	.615" (15.6 mm)	.40" (10.2 mm)	.422" (10.7 mm)	.312" (7.9 mm)	.83" (21 mm)	72" (1828.8 mm)
BX484	002112007084		.312" (7.9 mm)	.422" (10.7 mm)				.50" (12.7 mm)	84" (2132 mm)
BX484M	002112424084		.588" (15 mm)	.615" (15.6 mm)				.83" (21 mm)	84" (2132 mm)
BX496	002112007096		.312" (7.9 mm)	.422" (10.7 mm)				.50" (12.7 mm)	96" (2438.4 mm)
BX496M	002112424096		.588" (15 mm)	.615" (15.6 mm)				.83" (21 mm)	96" (2438.4 mm)
BX4120	002112007120		.312" (7.9 mm)	.422" (10.7 mm)				.50" (12.7 mm)	120" (3048 mm)
BX4120M	002112424120		.588" (15 mm)	.615" (15.6 mm)				.83" (21 mm)	120" (3048 mm)
BX4144	002112007144		.312" (7.9 mm)	.422" (10.7 mm)				.50" (12.7 mm)	144" (3655 mm)
BX4144M	002112424144		.588" (15 mm)	.615" (15.6 mm)				.83" (21 mm)	144" (3655 mm)
BX4240	002112007240		.312" (7.9 mm)	.422" (10.7 mm)				.50" (12.7 mm)	240" (6096 mm)
BX4240M	002112424240		.588" (15 mm)	.615" (15.6 mm)				.83" (21 mm)	240" (6096 mm)
BX3736	700014930036	.375" (9.5 mm)	.562" (14.26 mm)	.75" (19 mm)	.67" (17 mm)	.75" (19 mm)	.562" (14.26 mm)	.50" (12.7 mm)	36" (914.4 mm)
BX3748	700014930048								48" (1219.2 mm)
BX3772	700014930072								72" (1828.8 mm)
BX236	700014920036	.50" (12.7 mm)	.562" (14.26 mm)	.875" (22.2 mm)	.76" (19.3 mm)	.875" (22.2 mm)	.562" (14.26 mm)	.50" (12.7 mm)	36" (914.4 mm)
BX248	700014920048								48" (1219.2 mm)
BX272	700014920072								72" (1828.8 mm)

Vision Light Tech B.V.

Protonenlaan 22, 5405 NE UDEN, P.O. Box 345, 5400 AH UDEN, The Netherlands

Phone: +31 (0)413 26 00 67, Fax +31 (0)413 26 09 38, E-mail: inquiry@vlt.nl, Website: www.vlt.nl

Trade register No. 17150044, VAT No. NL8112.30.946.B01