

[illegible]

Model	Part #	A	B	C	D	E	F	G	H	L
BF624	002112306024									24" (609.60 mm)
BF636	002112306036	.063	.154	.020	.500	.190	.750	.207	.750	36" (914.40 mm)
BF648	002112306048	(1.60 mm)	(3.91 mm)	(.51 mm)	(12.7 mm)	(5.84 mm)	(19.05 mm)	(6.35 mm)	(19.05mm)	48" (1219.2 mm)
BF672	002112306072									72" (1828.8mm)
BF824	002112308024									24" (609.60 mm)
BF836	002112308036									36" (914.40 mm)
BF848	002112308048									48" (1219.2 mm)
BF860	002112308060	.125	.382	.032	.750	.230	1.00	.250	.750	60" (1524.0 mm)
BF872	002112308072	(3.18 mm)	(9.70 mm)	(.81 mm)	(19.05 mm)	(5.84 mm)	(25.4 mm)	(6.35 mm)	(19.05mm)	72"(1828.80mm)
BF896	002112308096									96"(2438.4mm)
BF8120	002112308120									120"(3048.0mm)
BF924	SK77190024	.138	1.50	.010	1.00	.300	1.50	-	2.00	24" (609.60 mm)
BF936	SK77190036	(3.51 mm)	(38.10mm)	(.254 mm)	(25.4 mm)	(7.62 mm)	(38.10mm)		(50.8 mm)	36" (914.40 mm)

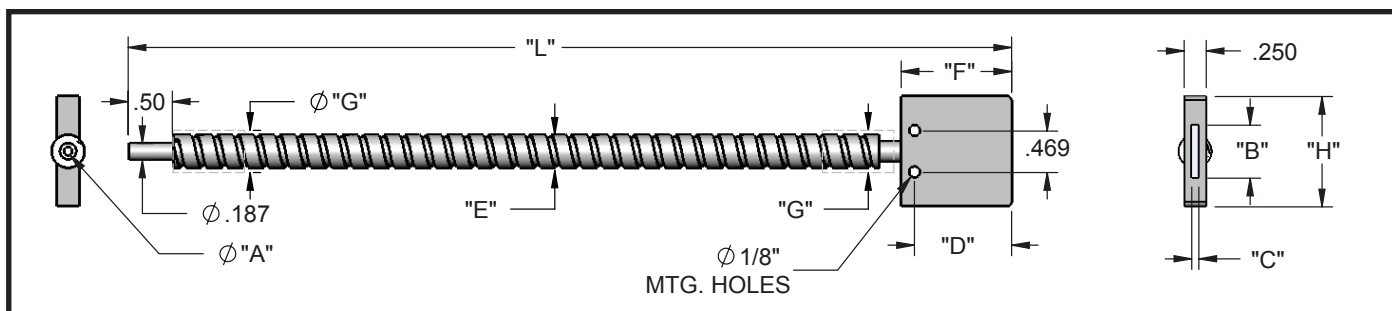

Model	Part #	A	B	C	D	E	F	G	H	L
BFX624 BFX636 BFX648 BFX672 BFX6120	002114306024 002114306036 002114306048 002114306072 002114306120	.063 (1.60 mm)	.154 (3.91 mm)	.020 (.51 mm)	.500 (12.7 mm)	.203 (5.16 mm)	.750 (19.05 mm)	-	.750 (19.05mm)	24" (609.60 mm) 36" (914.40 mm) 48" (1219.2 mm) 72"(1828.80mm) 120"(3048.0mm)
BFX824 BFX836 BFX848 BFX860 BFX872 BFX8180	002114308024 002114308036 002114308048 002114308060 002114308072 002114308180	.125 (3.18 mm)	.382 (9.70 mm)	.032 (.81 mm)	.750 (19.05 mm)	.244 (6.20 mm)	1.00 (25.4 mm)	-	.750 (19.05mm)	24" (609.60 mm) 36" (914.40 mm) 48" (1219.2 mm) 60" (1524.0 mm) 72"(1828.80mm) 180"(4572.0mm)
BFX924 BFX936 BFX948 BFX972	002114359024 002114359036 002114359048 002114359072	.138 (3.51 mm)	1.50 (38.10mm)	.010 (.254mm)	1.00 (25.4 mm)	.300 (7.62 mm)	1.50 (38.10mm)	-	2.00 (50.8 mm)	24" (609.60 mm) 36" (914.40 mm) 48" (1219.2 mm) 72"(1828.80mm)

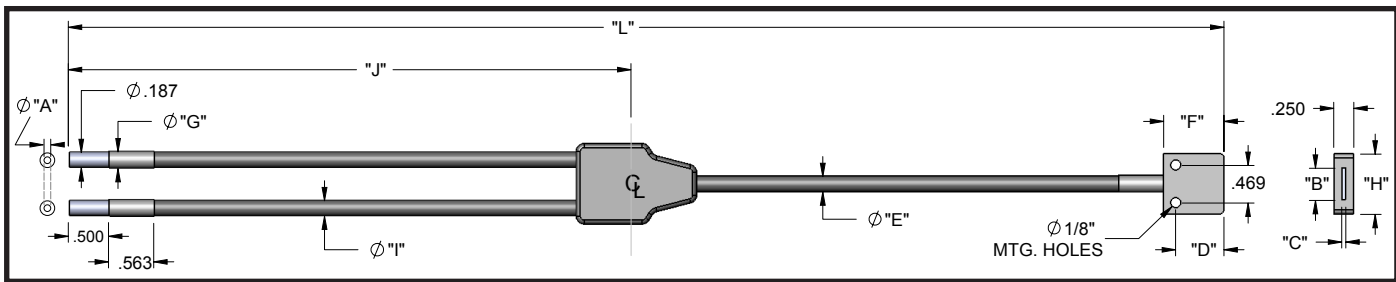

EF - 0.55NA Glass Fibers, Standard End Ferrule, PVC Monocoil Sheathing, Rated for -40°F to 221°F

Model	Part #	A	B	C	D	E	F	G	H	I	J	L
EF612	002122211012											12" (304.80 mm)
EF624	002122211024											24" (609.60 mm)
EF636	002122211036											36" (914.40 mm)
EF655	002122211055	.044 (1.12 mm)	.154 (3.91 mm)	.020 (.51 mm)	.500 (12.7 mm)	.190 (5.84 mm)	.750 (19.05 mm)	.207 (6.35 mm)	.750 (19.05 mm)	.190 (5.84 mm)	7.00 (177.8 mm)	55" (1397.0 mm)
EF660	002122211060											60" (1524.0 mm)
EF665	002122211065											65" (1651.0 mm)
EF672	002122211072											72" (1828.8 mm)
EF824	002122308024											24" (609.60 mm)
EF836	002122308036											36" (914.40 mm)
EF848	002122308048	.088 (2.24 mm)	.382 (9.70 mm)	.032 (.81 mm)	.750 (19.05 mm)	.220 (5.59 mm)	1.00 (25.4 mm)	.250 (6.35 mm)	.750 (19.05 mm)	.220 (5.59 mm)	7.00 (177.8 mm)	48" (1219.2 mm)
EF860	002122308060											60" (1524.0 mm)
EF872	002122308072											72" (1828.8 mm)
EF924	SK95540024	.138 (3.51 mm)	1.50 (38.10 mm)	.010 (.254 mm)	1.00 (25.4 mm)	.300 (7.62 mm)	1.50 (38.10 mm)	-	2.00 (50.8 mm)	.300 (7.62 mm)	7.00 (177.8 mm)	24" (609.60 mm)
EF936	SK95540036											36" (914.40 mm)

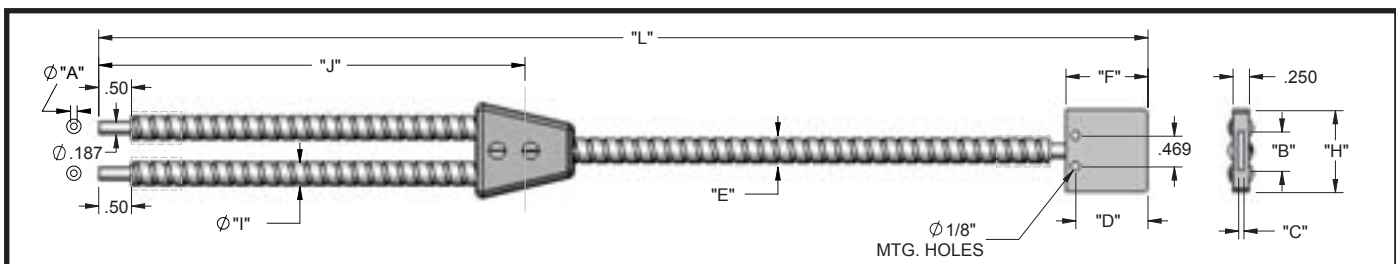

EFX & EEFX - 0.55NA Glass Fibers, Standard End Ferrule, Stainless Steel Sheathing, Rated for -40°F to 500°F

Model	Part #	A	B	C	D	E	F	H	I	J	L
EFX612	002124306012										12" (304.80 mm)
EFX624	002124306024										24" (609.60 mm)
EFX636	002124306036										36" (914.40 mm)
EFX648	002124306048										48" (1219.2 mm)
EFX672	002124306072										72" (1828.8 mm)
EFX824	002124308024										24" (609.60 mm)
EFX836	002124308036										36" (914.40 mm)
EFX848	002124308048	.088 (2.24 mm)	.382 (9.70 mm)	.032 (.81 mm)	.750 (19.05 mm)	.244 (6.20 mm)	1.00 (25.4 mm)	.750 (19.05 mm)	.244 (6.20 mm)	7.00 (177.8 mm)	48" (1219.2 mm)
EFX860	002124308060										60" (1524.0 mm)
EFX872	002124308072										72" (1828.8 mm)
EFX896	002124308096										96" (2438.4 mm)
EEFX918	700002060018									11"	18" (457.20 mm)
EEFX924	700002060024									17"	24" (609.60 mm)
EEFX936	700002060036	.138 (3.51 mm)	1.50 (38.10 mm)	.010 (.254 mm)	1.00 (25.4 mm)	.300 (7.62 mm)	1.50 (38.10 mm)	2.00 (50.8 mm)	.300 (7.62 mm)	29"	36" (914.40 mm)
EEFX948	700002060048									41"	48" (1219.2 mm)
EEFX972	700002060072									65"	72" (1828.8 mm)

Vision Light Tech B.V.

Protonenlaan 22, 5405 NE UDEN, P.O. Box 345, 5400 AH UDEN, The Netherlands

Phone: +31 (0)413 26 00 67, Fax +31 (0)413 26 09 38, E-mail: inquiry@vlt.nl, Website: www.vlt.nl

Trade register No. 17150044, VAT No. NL8112.30.946.B01