

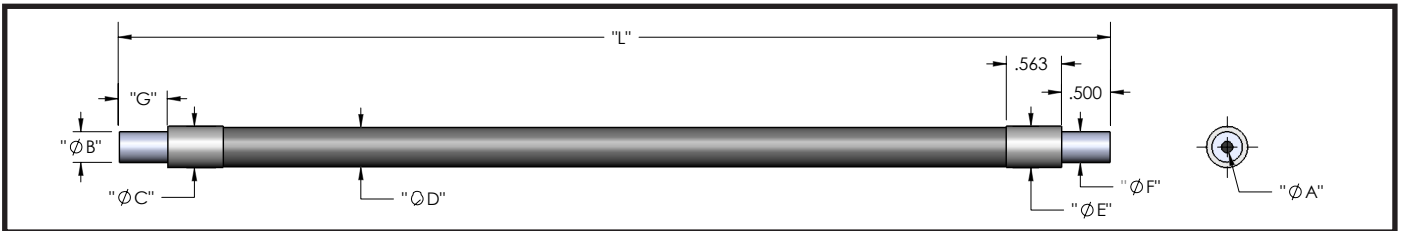

Optical Grade UV - Silica core/PCS clad

| Spectral Curve | Specifications |
|----------------|---------------------------|
| | Individual Fiber Diameter |
| | Acceptance Cone |
| | Numerical Aperture |
| | Fiber Material |
| | Temperature capabilities |
| | Spectral Transmittance |
| | Minimum Bend Radius |
| | Maximum Breakage |



BUV - Standard End Ferrule, PVC Monocoil Sheathing, Rated for -40°F to 221°F

| Model | Part # | A | B | C | D | E | F | G | L |
|--------|--------------|----------|----------|----------|----------|----------|----------|----------|-----------------|
| BUV612 | 002012016012 | | | | | | | | 12" (304.80 mm) |
| BUV624 | 002012016024 | | | | | | | | 24" (609.60 mm) |
| BUV636 | 002012016036 | | | | | | | | 36" (914.40 mm) |
| BUV648 | 002012016048 | .062" | .187" | .205" | .190" | .205" | .187" | .50" | 48" (1219.2 mm) |
| BUV660 | 002012016060 | (1.59mm) | (4.75mm) | (5.2mm) | (4.8mm) | (5.2mm) | (4.75mm) | (12.7mm) | 60" (1524.0 mm) |
| BUV672 | 002012016072 | | | | | | | | 72" (1828.8 mm) |
| BUV696 | 002012016096 | | | | | | | | 96" (2438.4 mm) |
| BUV806 | 002012018006 | | | | | | | | 06" (152.4 mm) |
| BUV809 | 002012018009 | | | | | | | | 09" (228.6 mm) |
| BUV810 | 002012018010 | | | | | | | | 10" (254.0 mm) |
| BUV812 | 002012018012 | | | | | | | | 12" (304.8 mm) |
| BUV824 | 002012018024 | | | | | | | | 24" (609.6 mm) |
| BUV836 | 002012018036 | .125" | .187" | .312" | .268" | .312" | .187" | .50" | 36" (914.40 mm) |
| BUV848 | 002012018048 | (3.18mm) | (4.75mm) | (7.92mm) | (6.81mm) | (7.92mm) | (4.75mm) | (12.7mm) | 48" (1219.2 mm) |
| BUV860 | 002012018060 | | | | | | | | 60" (1524.0 mm) |
| BUV872 | 002012018072 | | | | | | | | 72" (1828.8 mm) |
| BUV874 | 002012018074 | | | | | | | | 74" (1879.6 mm) |
| BUV884 | 002012018084 | | | | | | | | 84" (2133.6 mm) |
| BUV896 | 002012018096 | | | | | | | | 96" (2438.4 mm) |
| BUV412 | 002012014012 | | | | | | | | 12" (304.8 mm) |
| BUV416 | 002012014016 | | | | | | | | 16" (406.4 mm) |
| BUV424 | 002012014024 | .250" | .312" | .468" | .430" | .468" | .312" | .50" | 24" (609.60 mm) |
| BUV436 | 002012014036 | (6.35mm) | (7.92mm) | (11.9mm) | (10.9mm) | (11.9mm) | (7.92mm) | (12.7mm) | 36" (914.40 mm) |
| BUV460 | 002012014060 | | | | | | | | 60" (1524.0 mm) |
| BUV472 | 002012014072 | | | | | | | | 72" (1828.8 mm) |

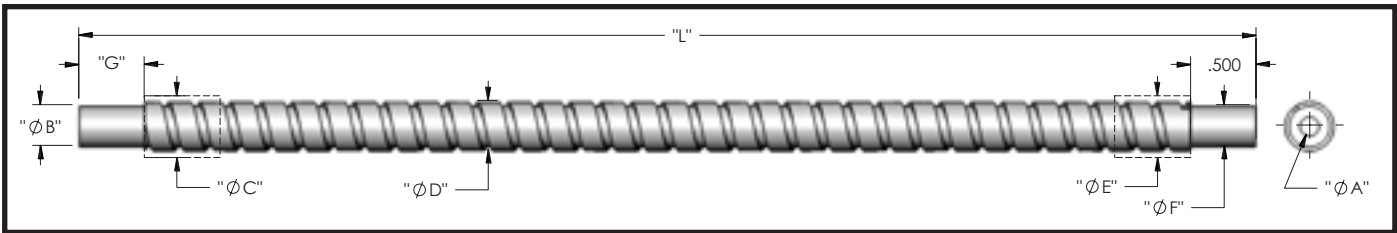

BXUV - Standard End Ferrule, Stainless Steel Sheathing, Rated for -40°F to 347°F

| Model | Part # | A | B | C | D | E | F | G | L |
|---------|--------------|----------|----------|----------|-----------|----------|----------|----------|-----------------|
| BXUV624 | 002014016024 | .062" | .187" | .286" | .203" | .286" | .187" | .50" | 24" (609.60 mm) |
| BXUV636 | 002014016036 | (1.59mm) | (4.75mm) | (7.23mm) | (5.15 mm) | (7.23mm) | (4.75mm) | (12.7mm) | 36" (914.40 mm) |
| BXUV824 | 002014018024 | .125" | .187" | .375" | .345" | .375" | .187" | .50" | 24" (609.60 mm) |
| BXUV836 | 002014018036 | (3.18mm) | (4.75mm) | (9.52mm) | (8.76mm) | (9.52mm) | (4.75mm) | (12.7mm) | 36" (914.40 mm) |
| BXUV860 | 002014018060 | | | | | | | | 60" (1524.0 mm) |
| BXUV424 | 002014014024 | .250" | .312" | .615" | .560" | .615" | .312" | .50" | 24" (609.60 mm) |
| BXUV436 | 002014014036 | (6.35mm) | (7.92mm) | (15.6mm) | (14.22mm) | (15.6mm) | (7.92mm) | (12.7mm) | 36" (914.40 mm) |
| BXUV460 | 002014014060 | | | | | | | | 60" (1524.0 mm) |

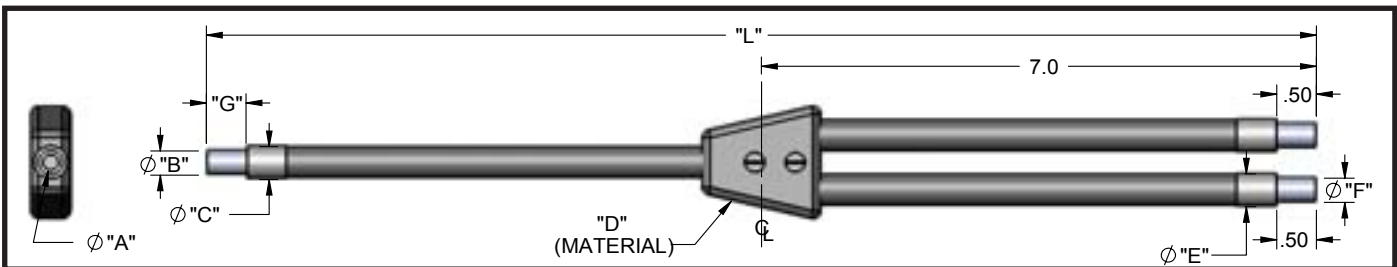

EUV - Standard End Ferrule, PVC Monocoil Sheathing, Rated for -40°F to 221°F

| Model | Part # | A | B | C | D | E | F | G | L |
|--------|--------------|----------|----------|----------|-----------------|----------|----------|----------|-----------------|
| EUV624 | 002022046024 | .062" | .187" | .253" | PVC Heat Shrink | .205" | .187" | .50" | 24" (609.60 mm) |
| EUV636 | 002022046036 | (1.59mm) | (4.75mm) | (6.42mm) | | (5.2mm) | (4.75mm) | (12.7mm) | 36" (914.40 mm) |
| EUV824 | 002022048024 | .125" | .187" | .312" | PVC Heat Shrink | .253" | .187" | .50" | 24" (609.60 mm) |
| EUV836 | 002022048036 | (3.18mm) | (4.75mm) | (7.92mm) | | (6.42mm) | (4.75mm) | (12.7mm) | 36" (914.40 mm) |
| EUV424 | 002022044024 | .250" | .312" | .468" | PVC Heat Shrink | .422" | .312" | .50" | 24" (609.60 mm) |
| EUV436 | 002022044036 | (6.35mm) | (7.92mm) | (11.9mm) | | (10.7mm) | (7.92mm) | (12.7mm) | 36" (914.40 mm) |
| EUV460 | 002022044060 | | | | | | | | 60" (1524.0 mm) |

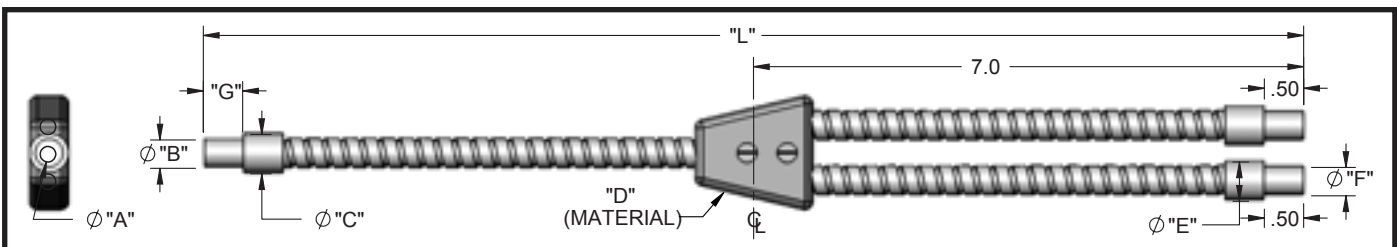

EXUV - Standard End Ferrule, Stainless Steel Sheathing, Rated for -40°F to 347°F

| Model | Part # | A | B | C | D | E | F | G | L |
|---------|--------------|----------|----------|---|------------------|---|----------|----------|-----------------|
| EXUV824 | 002024018024 | .125" | .187" | | Metal Transition | | .187" | .50" | 24" (609.60 mm) |
| EXUV836 | 002024018036 | (3.18mm) | (4.75mm) | - | | - | (4.75mm) | (12.7mm) | 36" (914.40 mm) |
| EXUV872 | 002024018072 | | | | | | | | 72" (1828.8 mm) |

Vision Light Tech B.V.

Protonenlaan 22, 5405 NE UDEN, P.O. Box 345, 5400 AH UDEN, The Netherlands

Phone: +31 (0)413 26 00 67, Fax +31 (0)413 26 09 38, E-mail: inquiry@vlt.nl, Website: www.vlt.nl

Trade register No. 17150044, VAT No. NL8112.30.946.B01